

# MOTION ACTIVATED LIGHT AND MIST!



AGES  
15+

# MISTING WITCH™

## MISTING HALLOWEEN PROP

**3AA** Batteries  
Included  
(for demo purposes only)

## MISTING HALLOWEEN PROP EERIE MIX OF LIGHTS, MIST & SPOOKY SOUNDS!

### SETTING UP YOUR MISTING WITCH™

KEEP ALL PLASTIC AND WIRE PARTS  
AWAY FROM CHILDREN

1. Carefully remove and discard "try me" wire.
2. Use a small screwdriver to remove the (2) screws that release the battery compartment located on bottom of the MISTING WITCH™. Pull to slide battery compartment out for access to batteries. See Fig. 1
3. Remove screw on battery compartment and replace demo batteries with (3) brand new "AA" alkaline batteries into the battery compartment. Replace screw and re-insert battery compartment into the bottom of MISTING WITCH™. Replace (2) screws that secure battery compartment to bottom of item.

TEXT CONTINUES ON PAGE 4

Water capacity:  
48 ml (1.62 fl oz)

INDOOR USE.

SURFACE WASHABLE ONLY.

All new materials:  
plastic, metal.

[TekkyDesign.com](http://TekkyDesign.com)

1

TEXT CONTINUED FROM PAGE 1

4. Twist water bottle (seated on bottom of MISTING WITCH™) COUNTER-CLOCKWISE to remove. See Fig. 2
5. Fill water bottle with clean, cool, room temperature water only. (Do not use oil/essential oil/fragrance/perfume.) See Fig. 3
6. Replace water bottle, twisting the bottle in a CLOCKWISE direction.

**NOTE:** Make sure not to over-tighten the bottle.

7. Place switch (located on bottom of item) to the "ON" position to operate in "TIMER" mode: lights/sound/misting operation with four minute breaks; move in front of item during four minute break to instantly restart scary sequence.
8. Place switch to "CONSTANT" to operate item in continuous play mode.

**NOTE:** First fill of tank could take up to 2 minutes of use to start misting effect.

#### FOR BEST RESULTS:

- Keep "function" switch in the "OFF" position when not in use.
- Place unit on place mat or towel if you are operating on a wood or easily damaged surface.
- Unit will stop misting when water level becomes too low.

4

### BOTTOM OF MISTING WITCH™

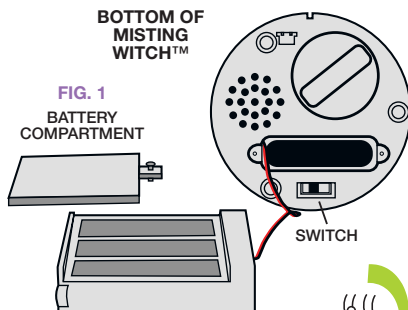

FIG. 1

BATTERY  
COMPARTMENT

FIG. 2

Turn  
handle  
counter-  
clockwise  
to access  
WATER  
BOTTLE.

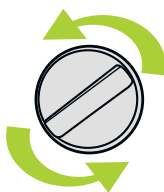

FIG. 3

Fill  
WATER  
BOTTLE  
with  
clean  
water.



2

### BATTERY INSTRUCTIONS AND CAUTIONS

- Battery installation and removal should be performed by an adult.
- Remove batteries when not in use.
- Use only batteries recommended in the instructions.
- Do not mix new and used batteries.
- Do not mix alkaline, carbon-zinc, nickel-cadmium, rechargeable or different types of batteries.
- Be mindful to insert batteries with the correct polarity (+/-) as indicated.
- Remove all exhausted batteries.
- Rechargeable batteries are only to be charged under adult supervision.
- Rechargeable batteries are to be removed from the item before being charged.
- Non-rechargeable batteries are not to be recharged.
- The supply terminals are not to be short-circuited.
- Always dispose of exhausted batteries properly.
- Do NOT dispose of batteries in fire, they may leak or explode.

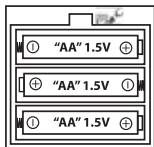

**WARNING! CHOKING HAZARD**—Small Parts.

This item is not a toy. For decoration only.

This product is intended for use by persons 15 years of age and older.  
Not intended for use by children 14 years of age and younger.

3



# MISTING WITCH™

Item #59069. MISTING WITCH™ is a trademark of Tekky.  
Copyright © 2020 Tekky. All Rights Reserved.



Manufactured for and distributed by:  
Tekky, Orland Park, IL 60467 USA  
MADE IN CHINA