

INSTRUCTION MANUAL



SET-UP INSTRUCTIONS FOR THE 8 FT ANIMATED LED FERRY OF THE DEAD



1-877-527-0313, 8 a.m. to 5 p.m., EST,
Monday-Friday



info@pan-asian.com.hk

Before you begin

3D-GUIDED INTERACTIVE ASSEMBLY
INSTRUCTIONS CAN BE FOUND ON **BILT**[®]
DOWNLOAD THE **FREE** APP



READ CAREFULLY & RETAIN FOR FUTURE REFERENCE!



Questions, problems, missing parts? Before returning to your retailer, call our customer service department at 1-877-527-0313, 8 a.m. to 5 p.m., EST, Monday-Friday or email at info@pan-asian.com.hk.



WARNING: This is not a toy and is for decorative purposes only. For incoor/outdoor use. This item is not intended for use by children under the age of 14. Do not place product near an open fire or heat source such as a radiator, stove, etc.



**KEEP OFF, DO NOT SIT OR CLIMB ON THE FERRY OF THE DEAD
THIS IS NOT A TOY. THIS ITEM IS FOR DECORATION ONLY.**

PREPARATION: Before beginning assembly the product, make sure that all parts are present. Compare parts with package contents list and diagram above. If any part is missing or damaged, do not attempt to assemble, install or operate the product. Contact customer service for replacement parts.

BATTERY USAGE:

ADULT SUPERVISION IS RECOMMENDED WHEN CHANGING BATTERIES.

1. Do not mix old and new batteries. 2. Do not mix alkaline, standard (carbon-zinc) or rechargeable (nickel-cadmium) batteries. 3. Alkaline batteries are suggested for longer life. 4. Exhausted batteries are to be removed from the product. 5. Dispose of exhausted batteries with care. 6. Do not dispose of batteries in fire, as they explode or leak.

CAUTION: Please remove batteries if the power is consumed or if the product is to be left unused for a long period of time.

RECYCLE YOUR BATTERIES: To help protect our environment, we recommend that all batteries be recycled. You can find a local recycling center by going to: <http://earth911.com/hazardous/single-use-batteries/> Or, in the United States call 1-800-CLEANUP for a recycling location near you.

IMPORTANT: This product can be powered by a UL Listed, 6 V, 1.5A adapter (included). Adapter should be plugged into 100-240 V household outlet.

SAFETY INSTRUCTIONS:

1. All cautions in these operating instructions should be followed completely.
2. Do not use near water; such as bathtub, laundry tub, kitchen sink, wet basement or swimming pool, etc.
3. Do not display figure near any heat source such as radiators, stoves, fireplaces, etc.
4. Display should be serviced by a qualified service person only. Do not attempt to service this unit beyond what is described in the operating instructions.
5. Take extra care when displaying any figure that may contain small parts around small children.
6. Use of this decoration should always be supervised by an adult.

WARNING: Changes or modifications to this unit not expressly approved by the party responsible for compliance could void the user's authority to operate the equipment.

NOTE: This equipment has been tested and found to comply with the limits for a Class B digital device, pursuant to Part 15 of the FCC Rules. These limits are designed to provide reasonable protection against harmful interference in a residential installation. This equipment generates, uses and can radiate radio frequency energy and, if not installed and used in accordance with the instructions, may cause harmful interference to radio communications. However, there is no guarantee that interference will not occur in a particular installation. If this equipment does cause harmful interference to radio or television reception, which can be determined by turning the equipment off and on, the user is encouraged to try to correct the interference by one or more of the following measures:

- Reorient or relocate the receiving antenna.
- Increase the separation between the equipment and receiver.
- Connect the equipment into an outlet on a circuit different from that to which the receiver is connected.
- Consult the dealer or experienced radio/TV technician for help.

BATTERY REPLACEMENT & ITEM FUNCTION:

Battery-powered. Requires 3 "AAA" batteries Skull and 3 "AAA" batteries for lantern (batteries are included).

1. Remove the battery case cover, which is located on the bottom of the skull or lantern. Using a small screw driver, unscrew the safety screw and then remove the battery compartment cover.
2. Clean the battery contacts and also those of the device prior to battery installation.
3. Insert new 3 "AAA" batteries with correct polarity and replace cover and safety screw.
4. Press the ON/OFF button one time for ON position to activate the LED lights and the timer feature. When the timer feature is activated, the lights will automatically turn ON for 6 hours and shut OFF for 18 hours. Press button two times for OFF position to activate short version demonstration.
5. Replace batteries if the LED begins to dim.

TO ACTIVATE REAPER:

1. Plug the AC/DC adapter into a standard 100-240V household outlet to activate animated reaper with motion, sound and lights. Unplug the power adapter when not in use.
2. The ON/OFF/DEMO switch is located on the sound box. Place the switch into the "ON" position for sound-activated mode. Clap your hands or make a loud noise to activate LED lights, motion and full version of the sound. Switch to the "DEMO" position to activate the "Try-Me" feature and then press the "Try-Me" button located on the left hand for short version demonstration. Switch to the "OFF" position and unplug AC/DC adapter when not in use.

TROUBLE SHOOTING:

Problem	Solution
The skull or lantern does not work	1. Check if the positive and negative terminals of the battery are installed correctly.
	2. Check whether the battery is drained. Replace the new batteries and try again.
the sound sensor does not work	1. Check the ON/OFF/DEMO switch is located in the "ON" position.
	2. Check if the triggered sound is too far from the reaper, please keep the distance between the sound and the horse at 39.5 in (100cm).
	3. Check if the triggered sound is too small, please activate the product with a trigger sound of more than 90 decibel.

If you are still experiencing problems with the product please call 1-877-527-0313 for further assistance.

DISTRIBUTED BY:
HOME DEPOT
2455 PACES FERRY ROAD
ATLANTA, GA 30339

04252021_2008482
Printed in China

PART LIST:

1 Front Right & Back Left



QTY 2

2 Front Left & Back Right



QTY 2

3 Right Middle



QTY 1

4 Left Middle



QTY 1

5 Front Top



QTY 1

6 Front Top Skull



QTY 1

7 Back Top



QTY 1

8 Lantern



QTY 1

9 Bones Kit



QTY 1

10 Skeleton



QTY 2

11 Front and back Support Rod for Boat



QTY 2

12 Back Support Rod for Boat



QTY 1

13 Skeleton Support Rod



QTY 1

14 Support Rod for Boat front and Back



QTY 2

15 Screws



QTY 16

16 Plastic Screwdriver



QTY 1

17 Fabric



QTY 1

18 Ground Stakes



QTY 6

Part list for Reaper

19 Support Rod Base



QTY 1

20 Reaper's Support Rod



QTY 2

21 Body



QTY 1

22 Hip Rod



QTY 1

23 Left Arm



QTY 1

24 Right Arm



QTY 1

25 Boat pole-Middle & Top



QTY 2

26 Boat pole-Bottom



QTY 1

27 Boat pole Skull



QTY 1

28 AC/DC adapter & Cable



QTY 1

29 Instructions Menu



QTY 1

NOTE: If any parts are broken or missing first call the customer care number 1-877-527-0313

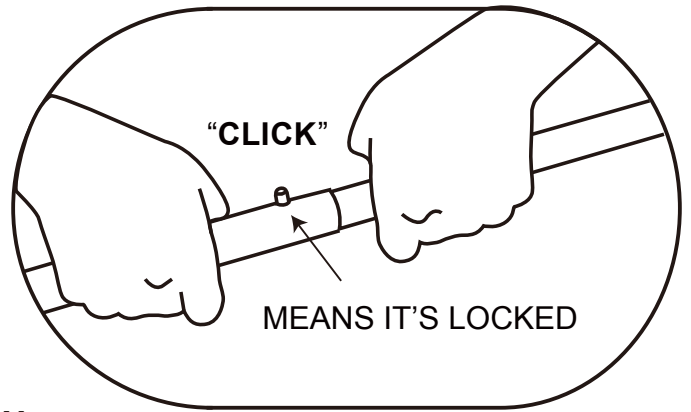
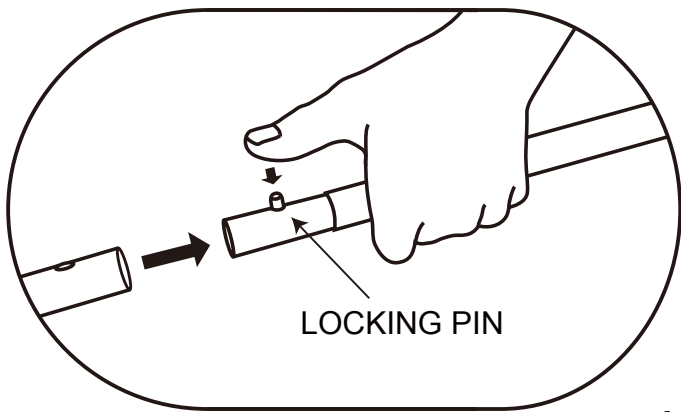

ASSEMBLY:
(Assembly Takes Approximately 45 Minutes with 2 Adults)

Step 1

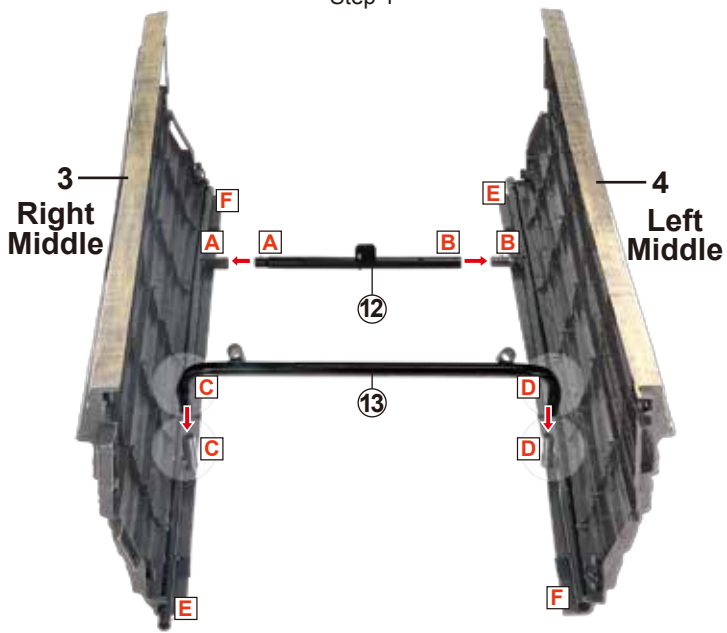

Step 2

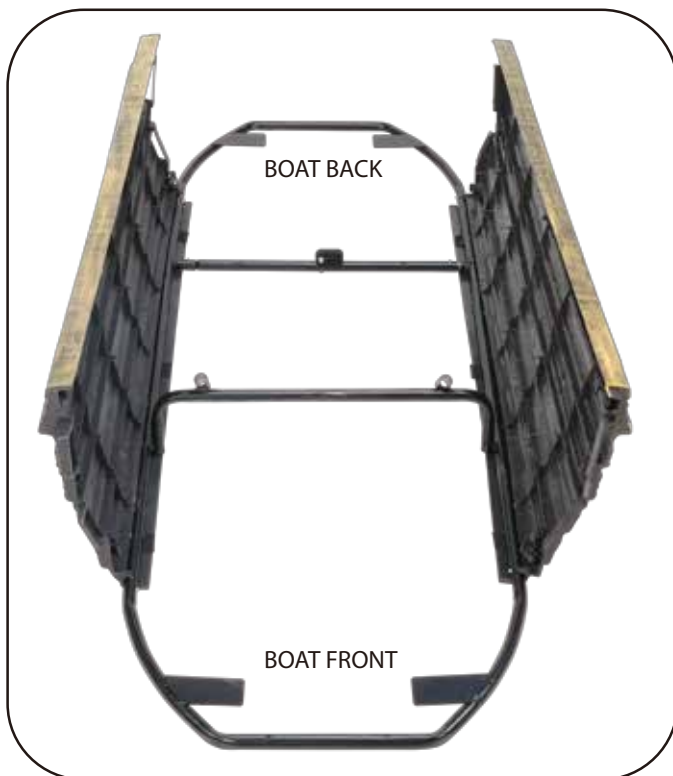
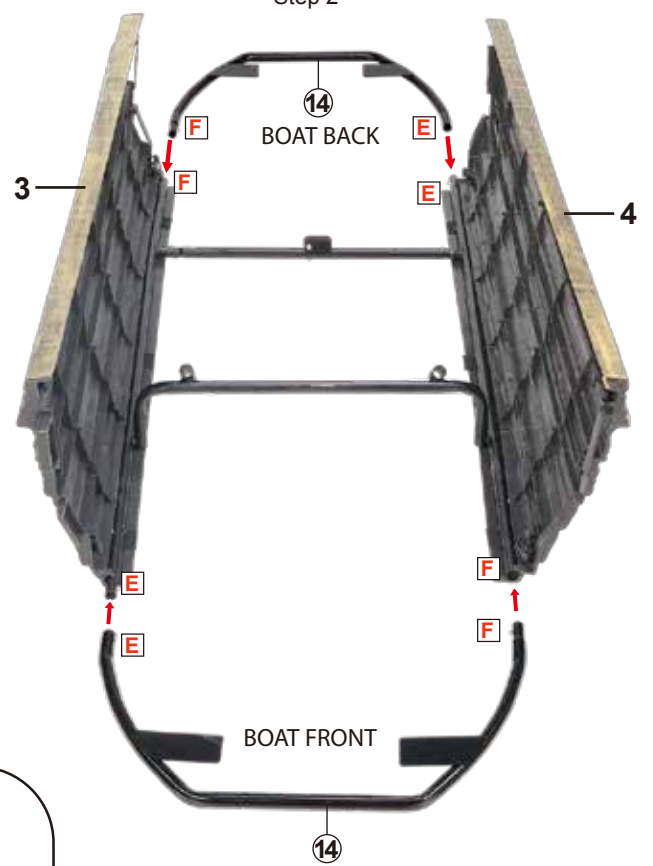

Step 3

Back View

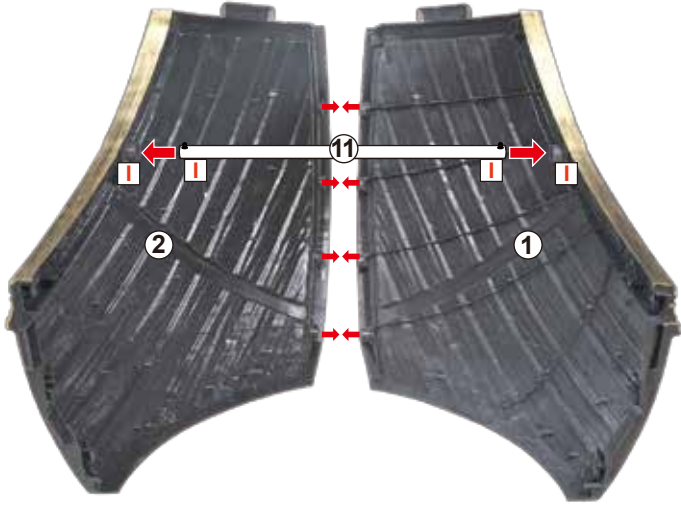

Front View

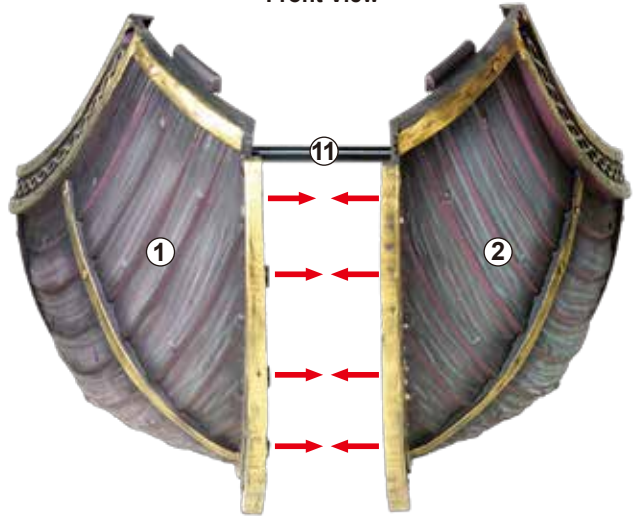

REPEAT STEP 3 AND STEP 4 TO ASSEMBLE THE OPPOSITE SIDE OF THE BOAT.

Step 4

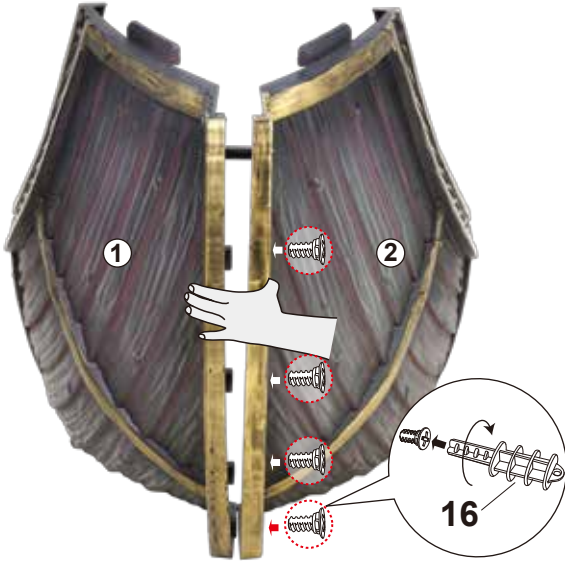

Use the plastic screw driver (16) and 4 x screws (15) to securely fasten the front right (1) to the front left (2) as shown. DO NOT OVERTIGHTEN

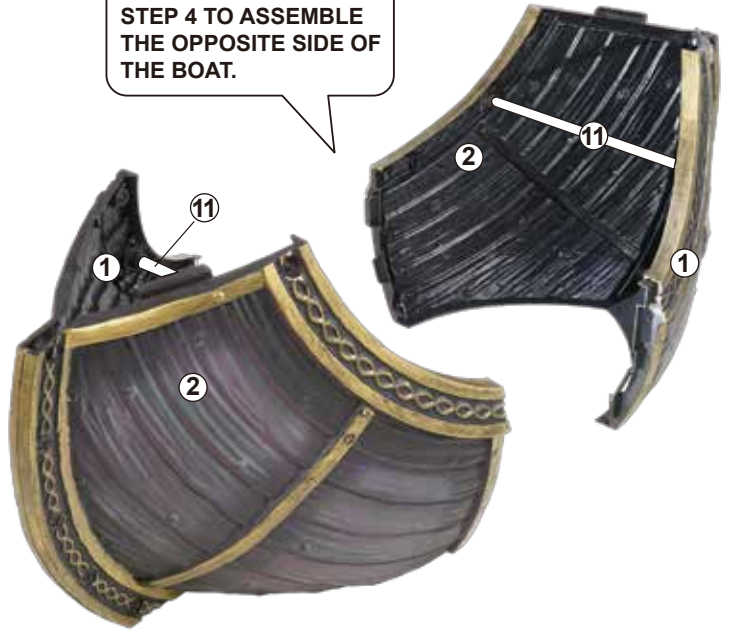

Step 5

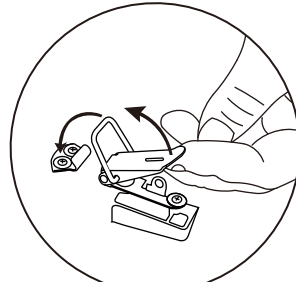

Close the (8) x "Locking Clips" located inside the boat parts onto the corresponding (8) x "Locking Clip Attachments" to fasten and secure the boat parts together.

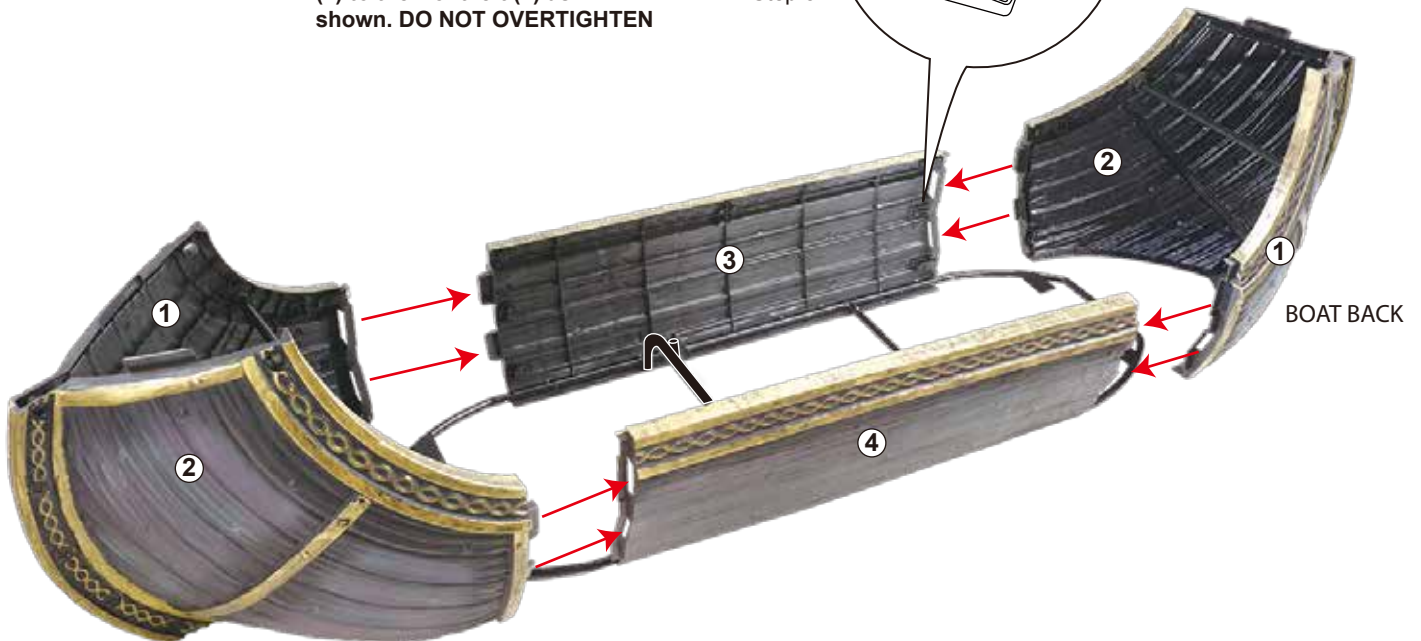

BOAT FRONT

BOAT BACK

Step 6

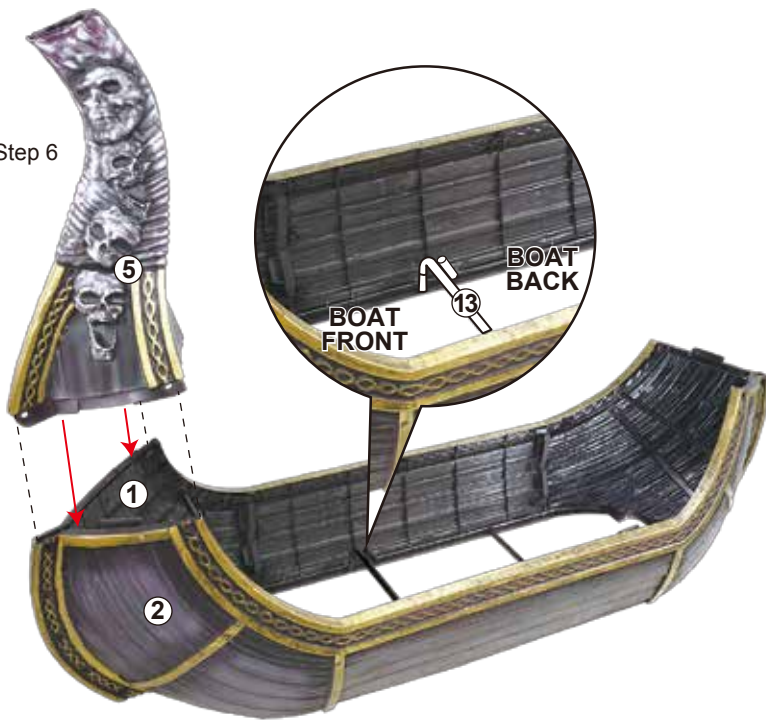

Step 7

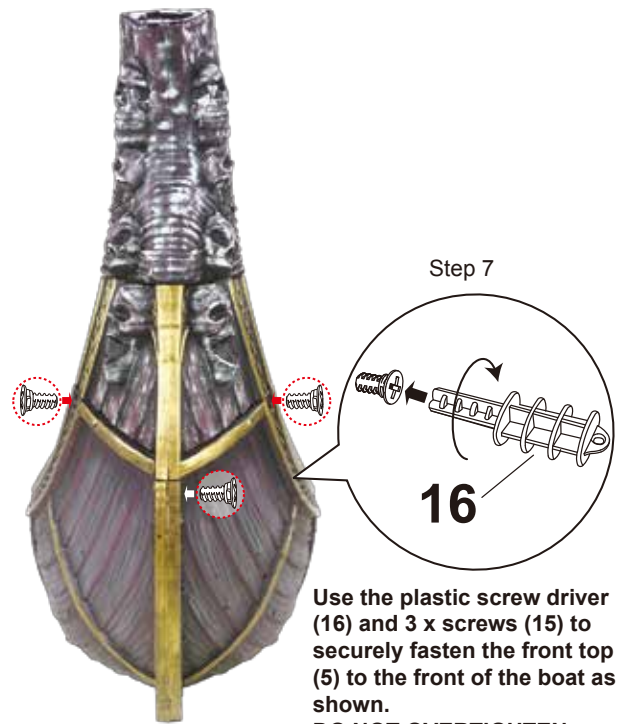

Use the plastic screw driver (16) and 3 x screws (15) to securely fasten the front top (5) to the front of the boat as shown.
DO NOT OVERTIGHTEN

Step 8

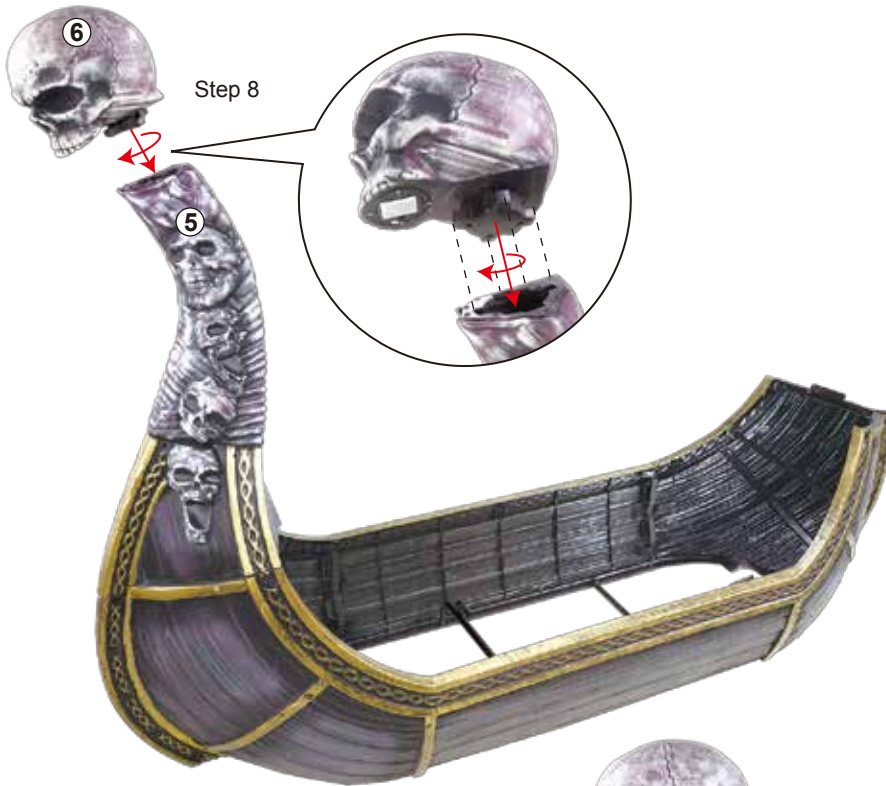

Step 9

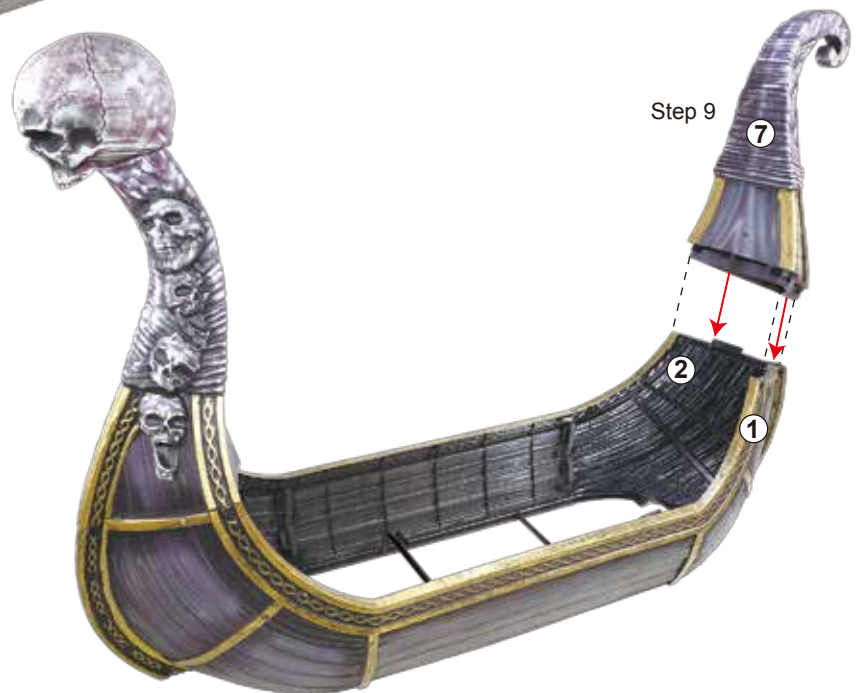



Step 11

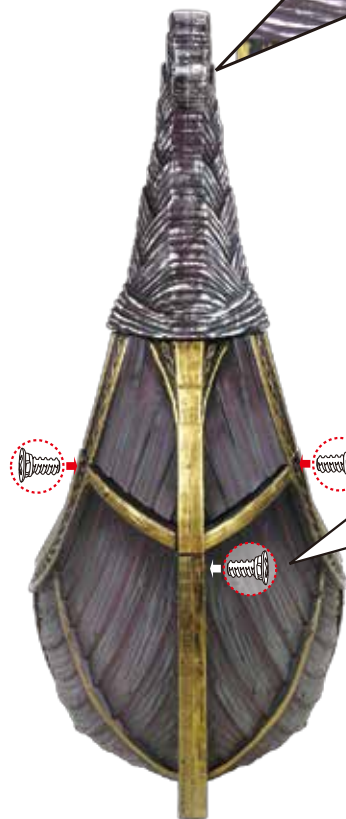

Step 10

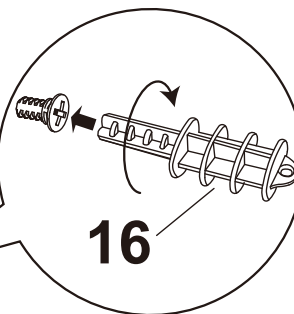

16

Use the plastic screw driver (16) and 3 x screws (15) to securely fasten the back top (7) to the back of the boat as shown.
DO NOT OVERTIGHTEN

Step 12

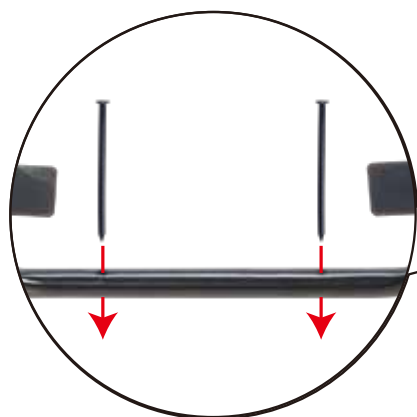

Insert 2 x ground stakes (18) through the corresponding holes located in the support rods (14) and push or gently hammer (not included) to secure into the ground for outdoor display stability as shown.

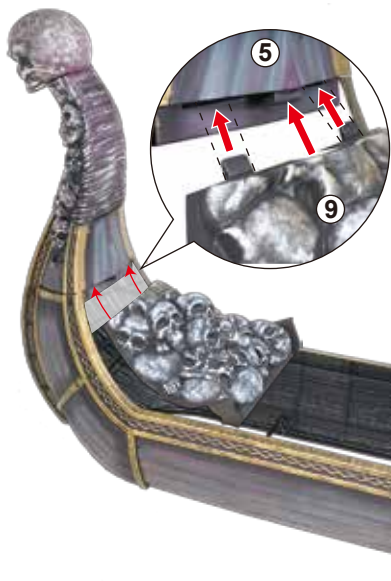

Step 12-1

Use the plastic screw driver (16) and 2 x screws (15) to securely fasten the bones kit (9) to the front of the boat as shown. **DO NOT OVERTIGHTEN**

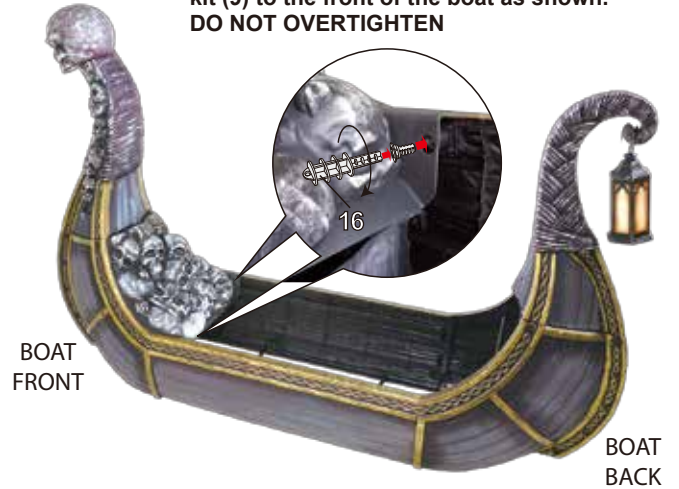

BOAT FRONT

BOAT BACK

INSTALLING THE FABRIC INTO THE BOTTOM OF THE BOAT

Step 13: Unpack and Unfold the black fabric (17)



BOAT FRONT



BOAT BACK

Step 14



Attach one end of the black fabric to the bones kit (9) by using the hook and loop tabs to secure into place as shown.

Step 15



Slide the black fabric under support rods (11, 12, 13, and 14), all the way to the opposite end of the boat. Using the hook and loop tabs to secure into place as shown.

Step 16



Attach the opposite end of the black fabric to the back top (7) by using the hook and loop tabs to secure into place as shown.



Completed Black Fabric Assembly

Step 17

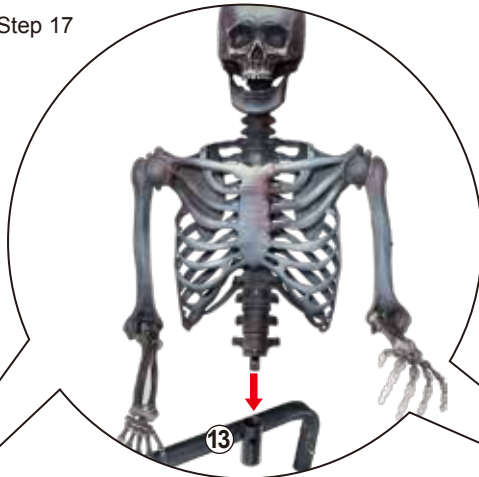
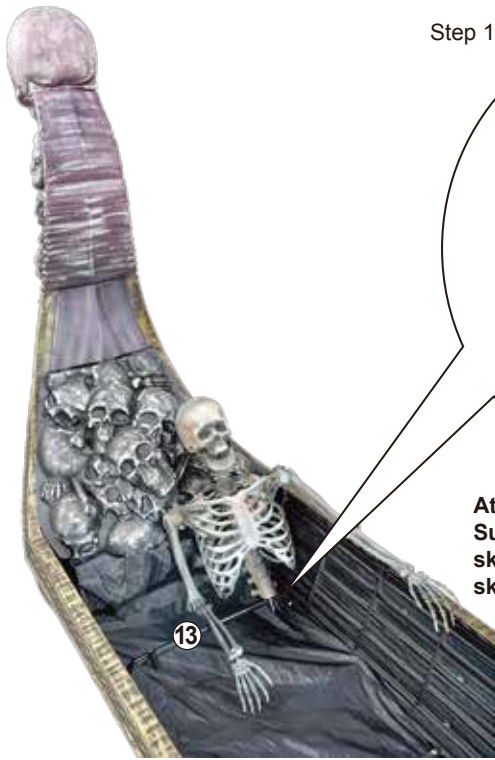

Attach the two skeletons onto the Skeleton Support Rods (13). NOTE: Please install left skeleton first and then install the right side skeleton. as shown.

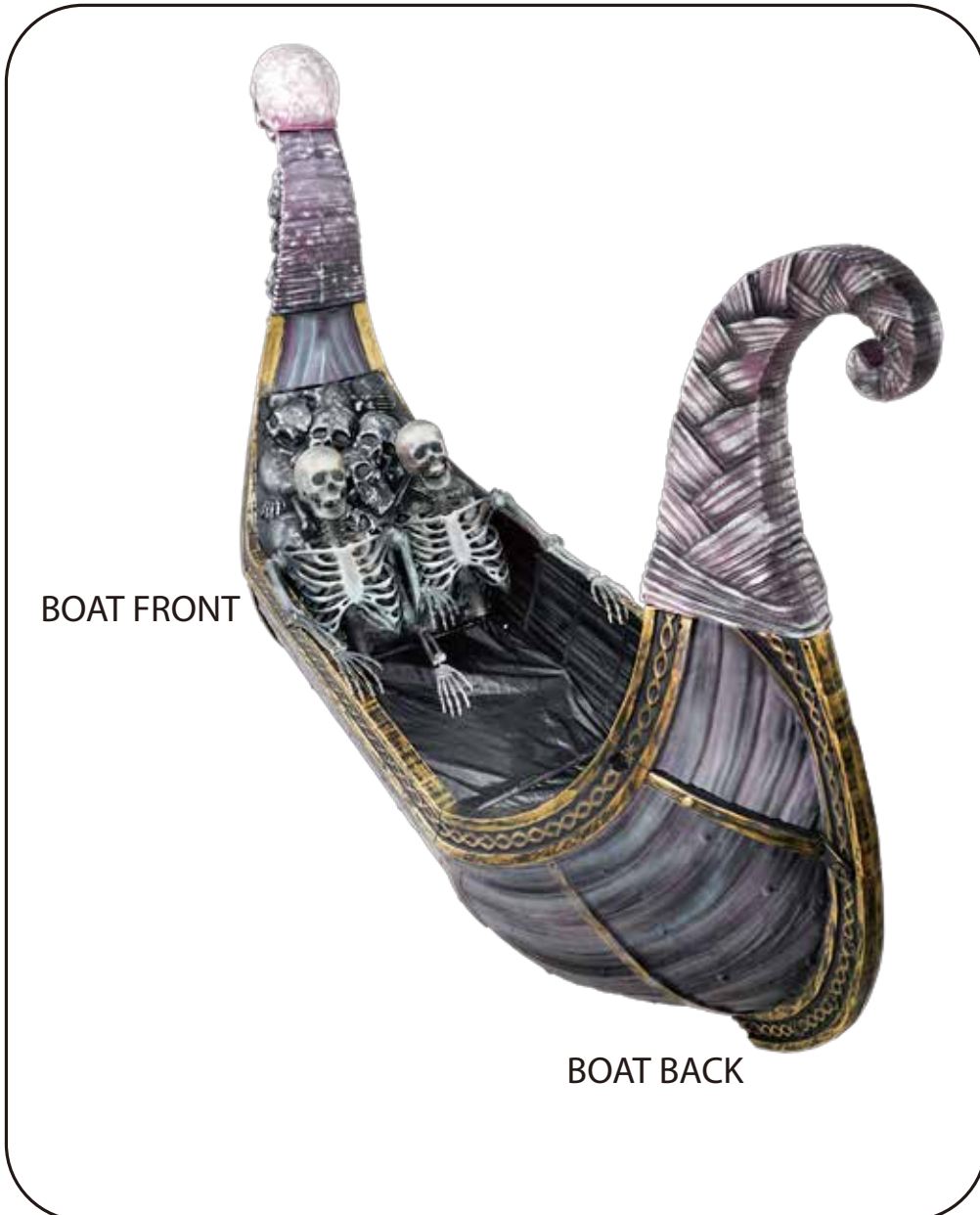

ASSEMBLING THE REAPER

Step 18

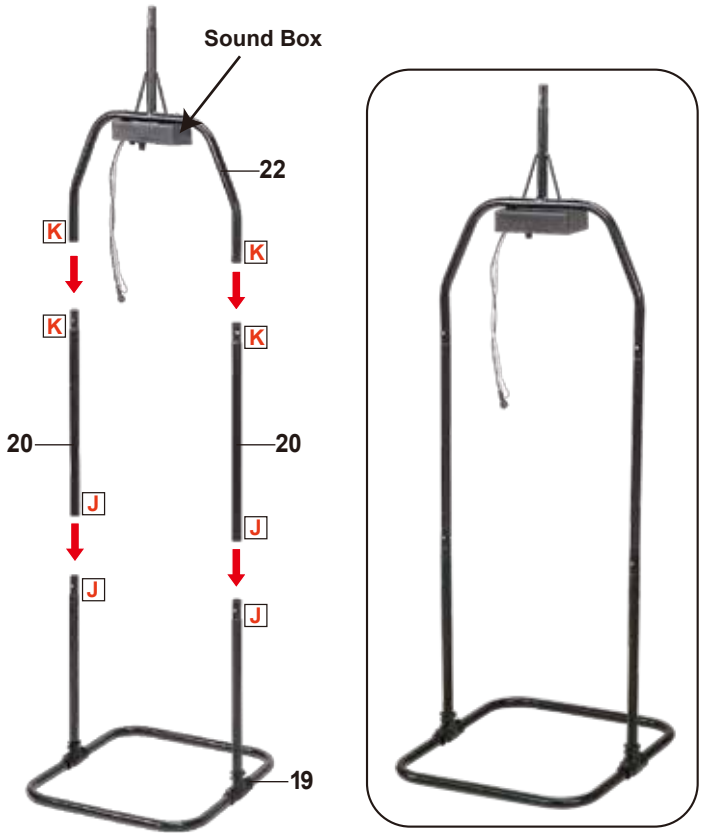

Step 19



Step 22



Step 23



Step 24



Attach the right sleeve of the costume to the right hand using the hook and loop tabs to secure in place as shown



Attach the left sleeve of the costume to the left hand using the hook and loop tabs to secure in place as shown

Step 25



Step 28

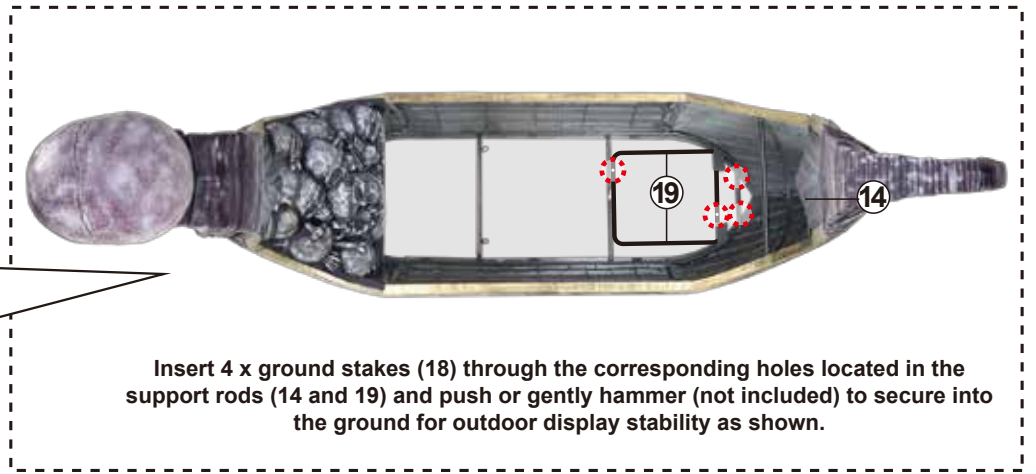
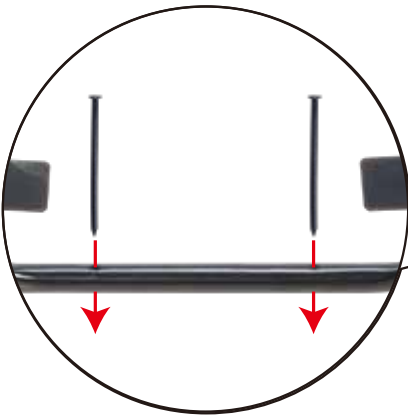

Insert 4 x ground stakes (18) through the corresponding holes located in the support rods (14 and 19) and push or gently hammer (not included) to secure into the ground for outdoor display stability as shown.

Step 29



Step 30



Attach the Fully Assembled Boat Pole into the clips inside both hands to secure into place as shown

Step 32



Press the function control switch located under the lantern to the "ON" position as shown

Step 31



Press the function control switch located under the skull to the "ON" position as shown





Fully Assembled Product

Step 33

Sound Box



AC Adapter
(DC 6V, 1.5A)

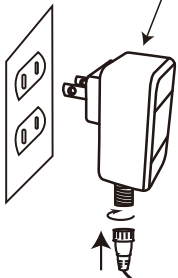

Plug adapter into 100-240V household outlet

LOCKING PIN

"CLICK"
MEANS IT'S LOCKED

ASSEMBLY:
(Assembly Takes Approximately 45 Minutes with 2 Adults)

Step 1
Right Middle
Left Middle

Step 2
BOAT BACK
BOAT FRONT

Step 3
Back View
Front View

REPEAT STEP 3 AND STEP 4 TO ASSEMBLE THE OPPOSITE SIDE OF THE BOAT.

Step 4
Close the (8) x "Locking Clips" located inside the boat parts onto the corresponding (8) x "Locking Clip Attachments" to fasten and secure the boat parts together.

Step 5
Use the plastic screw driver (16) and 4 x screws (15) to securely fasten the front right (1) to the front left (2) as shown. **DO NOT OVERTIGHTEN**

Step 6
BOAT BACK
BOAT FRONT

Step 7
Use the plastic screw driver (16) and 3 x screws (15) to securely fasten the front top (5) to the front of the boat as shown. **DO NOT OVERTIGHTEN**

Step 8

Step 9
BOAT FRONT
BOAT BACK

Step 10
Use the plastic screw driver (16) and 3 x screws (15) to securely fasten the back top (7) to the back of the boat as shown. **DO NOT OVERTIGHTEN**

Step 11
Use the plastic screw driver (16) and 2 x screws (16) to securely fasten the bones kit (9) to the front of the boat as shown. **DO NOT OVERTIGHTEN**

Step 12
Insert 2 x ground stakes (18) through the corresponding holes located in the support rods (14) and push or gently hammer (not included) to secure into the ground for outdoor display stability as shown.

INSTALLING THE FABRIC INTO THE BOTTOM OF THE BOAT

Step 13: Unpack and Unfold the black fabric (17)

Step 14
Attach one end of the black fabric to the bones kit (9) by using the hook and loop tabs to secure into place as shown.

Step 15
Slide the black fabric under support rods (11, 12, 13, and 14) all the way to the opposite end of the boat. Using the hook and loop tabs to secure into place as shown.

Step 16
Attach the opposite end of the black fabric to the back top (7) by using the hook and loop tabs to secure into place as shown.

Completed Black Fabric Assembly

Step 17
Attach the two skeletons onto the Skeleton Support Rods (13). NOTE: Please install left skeleton first and then install the right side skeleton, as shown.

ASSEMBLING THE REAPER

Step 18
Sound Box

Step 19
Align the two arrows, Connect the Black wires together and White wires together.

Step 20
Plug the Try Me wire into the port on the sound box as shown.

Step 21
Attach the right arm into the reaper

Step 22
Attach the right arm into the reaper

Step 23
Attach the left arm into the reaper

Step 24
Attach the right sleeve of the costume to the right hand using the hook and loop tabs to secure in place as shown.

Step 25
Attach the left sleeve of the costume to the left hand using the hook and loop tabs to secure in place as shown.

Step 26
Press the function control switch located under the skull to the "ON" position as shown.

Step 27
Press the function control switch located under the skull to the "ON" position as shown.

Step 28
Insert 4 x ground stakes (18) through the corresponding holes located in the support rods (14 and 19) and push or gently hammer (not included) to secure into the ground for outdoor display stability as shown.

Step 29

Step 30
Attach the Fully Assembled Reaper Pole into the clips located inside both hands to secure into place as shown.

Step 31
Press the function control switch located under the skull to the "ON" position as shown.

Step 32
Press the function control switch located under the skull to the "ON" position as shown.

Step 33
Sound Box

Fully Assembled Product

AC Adapter (DC 6V, 1.5A)

Plug adapter into 100-240V household outlet